



13DS2 SERIES

1000VDC DUAL OUTPUT 1 WATT DC-DC CONVERTER

FEATURES

- 18 PIN SMD PACKAGE.
- 1000VDC ISOLATION.
- UNREGULATED OUTPUT TYPES.
- UL 94V-0 PACKAGE MATERIAL.
- WIND TEMPERATURE PERFORMANCE AT FULL 1 WATT LOAD -40°C TO 85°C



GENERAL SPECIFICATIONS

- ISOLATION RESISTANCE :1000MΩ MIN @1000VDC
- SWITCHING FREQUENCY :115KHz TYP.
- OPERATING TEMPERATURE :-40 °C TO 85°C
- ISOLATION VOLTAGE :1000 VDC MIN
- RIPPLE AND NOISE :110 mVp-p MAX

ELECTRICAL SPECIFICATIONS

- INPUT VOLTAGE RANGE :±10%
- OUTPUT VOLTAGE TOLERANCE :±5%
- LINE REGULATION(10% TO 100% F.L.) :±1.2%/1% OF Vin
- LOAD REGULATION(10% TO 100% F.L.)
5V & 9V OUTPUT TYPES :12% & 8.0% MAX
12V & 15V OUTPUT TYPES :8.5% & 7.0% MAX

Specifications typical at TA=25°C, nominal input voltage and rated output current unless otherwise specified

PART NUMBER	NOMINAL OUTPUT VOLTAGE	OUTPUT VOLTAGE	OUTPUT CURRENT	INPUT CURRENT AT RATED LOAD	RIPPLE AND NOISE	EFFICIENCY	ISOLATION CAPACITANCE
	(V)	(V)	(mA)	(mA)	(mVp-p)	(%)	(pF)
13DS2-05D05N	5	5	±100	290	100	69	33
13DS2-05D09N	5	9	±55	267	80	75	38
13DS2-05D12N	5	12	±42	260	110	77	44
13DS2-05D15N	5	15	±33	256	110	78	43
13DS2-12D05N	12	5	±100	121	100	69	50
13DS2-12D09N	12	9	±55	113	80	74	72
13DS2-12D12N	12	12	±42	111	110	75	89
13DS2-12D15N	12	15	±33	110	110	76	100

MARKINGS AND DIMENSIONS

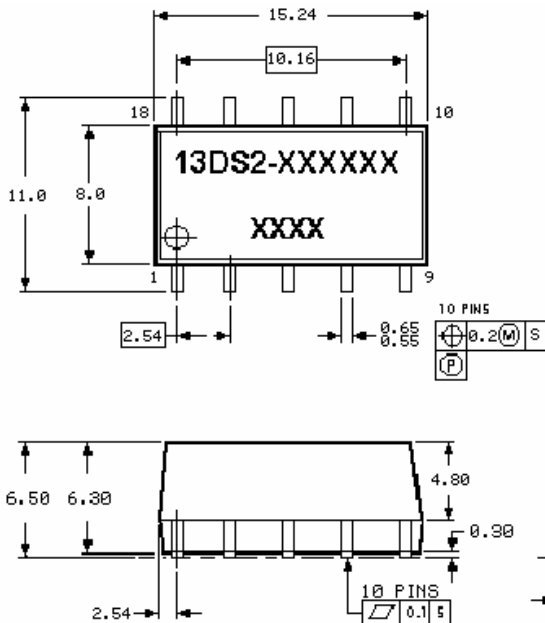

PIN CONNECTION

DETAIL A

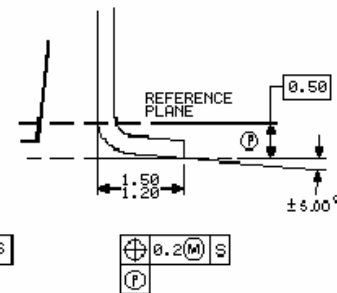

PIN	DUAL OUTPUT
1	-INPUT
3	+INPUT
5	NC
7	COMMON
9	-OUTPUT
10	NC
12	+OUTPUT
14	NC
16	NC
18	NC

Dimensions: mm

Unless otherwise specified, all tolerances are ±0.13